



# VENTURE POINT COMMERCE CENTER

FOR SALE OR LEASE

Southwest Corner of Park Avenue & Nevada Street in Redlands, California

BUILDING	ADDRESS	SQAURE FEET TOTAL	OFFICE SF	MEZZANINE SF	DOCK HIGH DOORS	GROUND LOADING DOORS	POWER	CLEAR HEIGHT
A	1911 Park Avenue	27,135	1,038	912	2	1	400 Amps	24'
B	1921 Park Avenue	14,048	1,038	912	1	1	400 Amps	24'
C	1931 Park Avenue	18,678	1,038	912	2	1	400 Amps	24'
D	1959 Park Avenue	21,612	1,038	912	2	1	400 Amps	24'

Another Quality Project of:

## VENTURE POINT DEVELOPMENT

INVESTMENT • DEVELOPMENT • PROGRAM MANAGEMENT

Phone: 949.673.4660 Fax: 949.673.4540

[www.venturepointinc.com](http://www.venturepointinc.com)

Exclusively Offered By:

**Kent Hindes**

[kent.hindes@cushwake.com](mailto:kent.hindes@cushwake.com)

909.942.4654

**Kyle Kehner**

[kyle.kehner@cushwake.com](mailto:kyle.kehner@cushwake.com)

909.942.4645

**Tim Pimentel**

[tim.pimentel@cushwake.com](mailto:tim.pimentel@cushwake.com)

909.942.4647

No warranty or representation, express or implied, is made as to the accuracy of the information contained herein, and same is submitted subject to errors, omissions, change of price, rental or other conditions, withdrawal without notice, and to any special listing conditions, imposed by our principals.



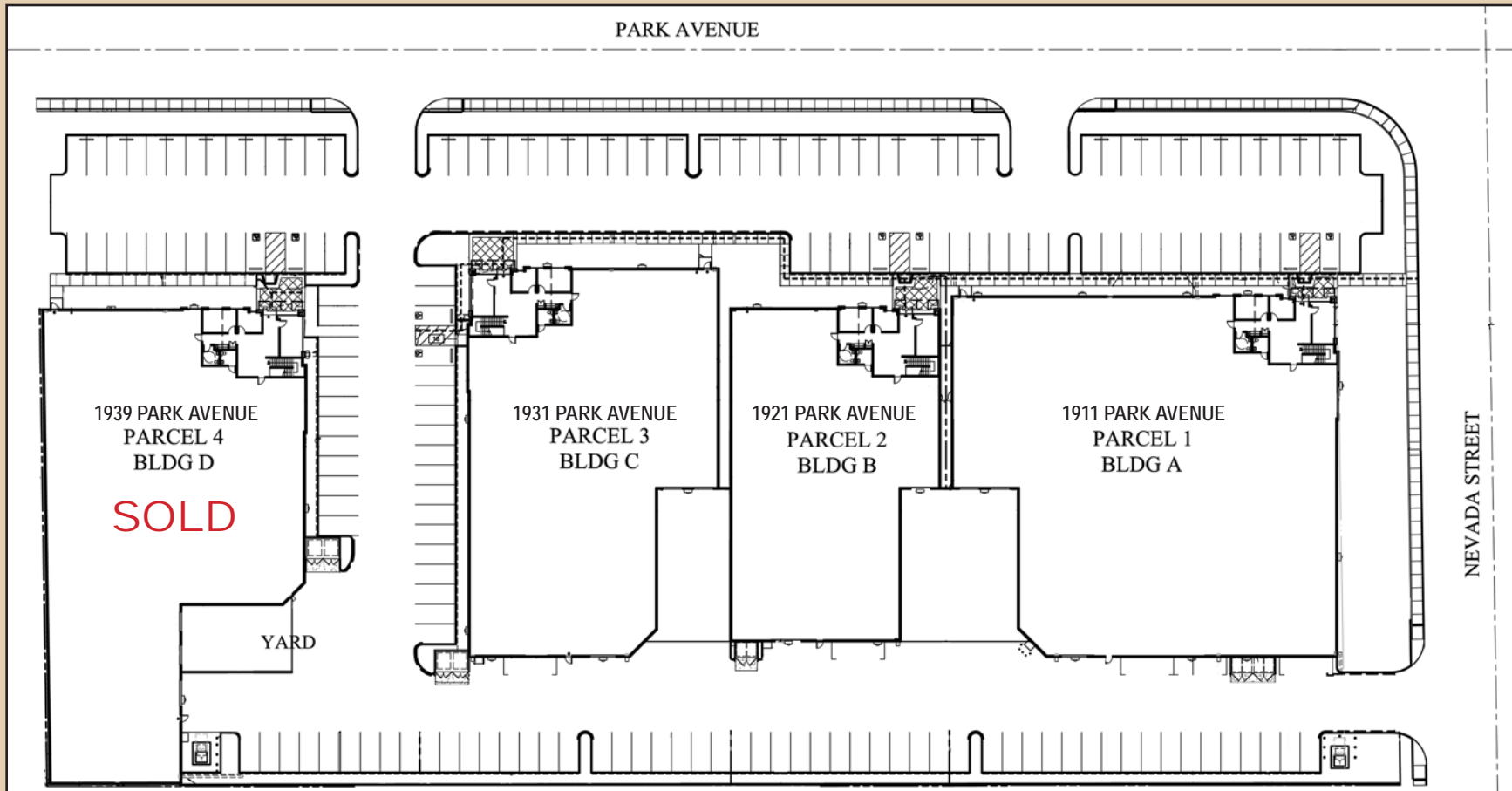

## VENTUREPOINT COMMERCE CENTER

Another Quality Project of:

### VENTUREPOINT DEVELOPMENT

INVESTMENT • DEVELOPMENT • PROGRAM MANAGEMENT

Phone: 949.673.4660 Fax: 949.673.4540

[www.venturepointinc.com](http://www.venturepointinc.com)

Exclusively Offered By:

**Kent Hindes**

[kent.hindes@cushwake.com](mailto:kent.hindes@cushwake.com)

**Kyle Kehner**

[kyle.kehner@cushwake.com](mailto:kyle.kehner@cushwake.com)

**Tim Pimentel**

[tim.pimentel@cushwake.com](mailto:tim.pimentel@cushwake.com)

**909.980.7788**

3800 Concours Street, #300  
Ontario, CA 91764

No warranty or representation, express or implied, is made as to the accuracy of the information contained herein, and same is submitted subject to errors, omissions, change of price, rental or other conditions, withdrawal without notice, and to any special listing conditions, imposed by our principals.

